

9" Bench Band Saw

(Model 28-150)



PART NO. 900070-0010
Copyright © 2000 Delta Machinery



To learn more about DELTA MACHINERY
visit our website at: www.deltamachinery.com.

For Parts, Service, Warranty or other Assistance,

please call **1-888-848-5175** (in Canada call **1-800-463-3582**).

ESPAÑOL: PÁGINA 25

SAFETY RULES

Woodworking can be dangerous if safe and proper operating procedures are not followed. As with all machinery, there are certain hazards involved with the operation of the product. Using the machine with respect and caution will considerably lessen the possibility of personal injury. However, if normal safety precautions are overlooked or ignored, personal injury to the operator may result. Safety equipment such as guards, push sticks, hold-downs, featherboards, goggles, dust masks and hearing protection can reduce your potential for injury. But even the best guard won't make up for poor judgment, carelessness or inattention. **Always use common sense** and exercise **caution** in the workshop. If a procedure feels dangerous, don't try it. Figure out an alternative procedure that feels safer. **REMEMBER:** Your personal safety is your responsibility.

This machine was designed for certain applications only. Delta Machinery strongly recommends that this machine not be modified and/or used for any application other than that for which it was designed. If you have any questions relative to a particular application, **DO NOT** use the machine until you have first contacted Delta to determine if it can or should be performed on the product.

Technical Service Manager
Delta Machinery
4825 Highway 45 North
Jackson, TN 38302-2468
(IN CANADA: 505 SOUTHGATE DRIVE, GUELPH, ONTARIO N1H 6M7)

WARNING: FAILURE TO FOLLOW THESE RULES MAY RESULT IN SERIOUS PERSONAL INJURY

- 1. FOR YOUR OWN SAFETY, READ INSTRUCTION MANUAL BEFORE OPERATING THE TOOL.** Learn the tool's application and limitations as well as the specific hazards peculiar to it.
- 2. KEEP GUARDS IN PLACE** and in working order.
- 3. ALWAYS WEAR EYE PROTECTION.**
- 4. REMOVE ADJUSTING KEYS AND WRENCHES.** Form habit of checking to see that keys and adjusting wrenches are removed from tool before turning it **"ON."**
- 5. KEEP WORK AREA CLEAN.** Cluttered areas and benches invite accidents.
- 6. DON'T USE IN DANGEROUS ENVIRONMENT.** Don't use power tools in damp or wet locations, or expose them to rain. Keep work area well-lighted.
- 7. KEEP CHILDREN AND VISITORS AWAY.** All children and visitors should be kept a safe distance from work area.
- 8. MAKE WORKSHOP CHILDPROOF** – with padlocks, master switches, or by removing starter keys.
- 9. DON'T FORCE TOOL.** It will do the job better and be safer at the rate for which it was designed.
- 10. USE RIGHT TOOL.** Don't force tool or attachment to do a job for which it was not designed.
- 11. WEAR PROPER APPAREL.** No loose clothing, gloves, neckties, rings, bracelets, or other jewelry to get caught in moving parts. Nonslip footwear is recommended. Wear protective hair covering to contain long hair.
- 12. ALWAYS USE SAFETY GLASSES.** Wear safety glasses. Everyday eyeglasses only have impact resistant lenses; they are not safety glasses. Also use face or dust mask if cutting operation is dusty.
- 13. SECURE WORK.** Use clamps or a vise to hold work when practical. It's safer than using your hand and frees both hands to operate tool.
- 14. DON'T OVERREACH.** Keep proper footing and balance at all times.
- 15. MAINTAIN TOOLS IN TOP CONDITION.** Keep tools sharp and clean for best and safest performance. Follow instructions for lubricating and changing accessories.
- 16. DISCONNECT TOOLS** before servicing and when changing accessories such as blades, bits, cutters, etc.
- 17. USE RECOMMENDED ACCESSORIES.** The use of accessories and attachments not recommended by Delta may cause hazards or risk of injury to persons.
- 18. REDUCE THE RISK OF UNINTENTIONAL STARTING.** Make sure switch is in "OFF" position before plugging in power cord.
- 19. NEVER STAND ON TOOL.** Serious injury could occur if the tool is tipped or if the cutting tool is accidentally contacted.
- 20. CHECK DAMAGED PARTS.** Before further use of the tool, a guard or other part that is damaged should be carefully checked to ensure that it will operate properly and perform its intended function – check for alignment of moving parts, binding of moving parts, breakage of parts, mounting, and any other conditions that may affect its operation. A guard or other part that is damaged should be properly repaired or replaced.
- 21. DIRECTION OF FEED.** Feed work into a blade or cutter against the direction of rotation of the blade or cutter only.
- 22. NEVER LEAVE TOOL RUNNING UNATTENDED. TURN POWER OFF.** Don't leave tool until it comes to a complete stop.
- 23. DRUGS, ALCOHOL, MEDICATION.** Do not operate tool while under the influence of drugs, alcohol or any medication.
- 24. MAKE SURE TOOL IS DISCONNECTED FROM POWER SUPPLY** while motor is being mounted, connected or reconnected.
- 25. THE DUST GENERATED BY CERTAIN WOODS** and wood products can be injurious to your health. Always operate machinery in well ventilated areas and provide for proper dust removal. Use wood dust collection systems whenever possible.
- 26. WARNING: SOME DUST CREATED BY POWER SANDING, SAWING, GRINDING, DRILLING, AND OTHER CONSTRUCTION ACTIVITIES** contains chemicals known to cause cancer, birth defects or other reproductive harm. Some examples of these chemicals are:
 - lead from lead-based paints,
 - crystalline silica from bricks and cement and other masonry products, and
 - arsenic and chromium from chemically-treated lumber.

Your risk from these exposures varies, depending on how often you do this type of work. To reduce your exposure to these chemicals: work in a well ventilated

area, and work with approved safety equipment, such as those dust masks that are specially designed to filter out microscopic particles.

SAVE THESE INSTRUCTIONS

ADDITIONAL SAFETY RULES FOR BAND SAWS

1. **DO NOT OPERATE YOUR BAND SAW UNTIL** it is completely assembled and installed according to the instructions.
2. **IF YOU ARE NOT** thoroughly familiar with the operation of band saws, obtain advice from your supervisor, instructor, or other qualified person.
3. **ALWAYS WEAR EYE PROTECTION.**
4. **NEVER** turn the machine “ON” before clearing the table of all objects (tools, scrap pieces, etc.).
5. **NEVER** start the band saw with the workpiece contacting the saw blade.
6. **ADJUST** the upper guide assembly by no more than 1/4" above the material being cut.
7. **MAKE SURE** the blade tension and blade tracking are properly adjusted.
8. **ALWAYS** keep hands and fingers away from the blade.
9. **CHECK** for proper blade size and type.
10. **DO NOT** attempt to saw stock that does not have a flat surface, unless a suitable support is used.
11. **HOLD** material firmly against the table and feed into blade at a moderate speed.
12. **TURN OFF** machine if the material is to be backed out of an uncompleted cut.
13. **MAKE** “relief” cuts before cutting long curves.
14. **DO NOT** remove jammed cut-off pieces until blade has stopped.
15. **STOP** the machine before removing scrap pieces from the table.
16. **NEVER** perform layout, assembly, or set-up work on the table while the machine is operating.
17. **ALWAYS WEAR PROPER EAR PROTECTION.**
18. **AVOID** awkward hand positions where a sudden slip could cause a hand to move into the blade.
19. **DO NOT** cut material that is too small to be safely supported.
20. **MAKE SURE** the blade teeth point downward toward the table.
21. **ALWAYS** maintain proper adjustment of blade tension, blade guides, and blade support bearings.
22. **SHUT OFF** the power and clean the table and work area before leaving the machine.
23. **SHOULD** any part of your band saw be missing, damaged, or fail in any way, or any electrical component fail to perform properly, shut off switch and remove plug from power supply outlet. Replace missing, damaged, or failed parts before resuming operation.
24. **THE USE** of attachments and accessories not recommended by Delta may result in the risk of injuries.
25. **ADDITIONAL INFORMATION** regarding the safe and proper operation of this product is available from the National Safety Council, 1121 Spring Lake Drive, Itasca, IL 60143-3201 in the Accident Prevention Manual for Industrial Operation and also in the Safety Data Sheets provided by the NSC. Please also refer to the American National Standards Institute ANSI 01.1 Safety Requirements for Woodworking Machinery and the U.S. Department of Labor OSHA 1910.213 Regulations.
26. **DO NOT EXPOSE TO RAIN** or use in damp location.
27. **When** the tool is not in use, the switch should be locked in the “OFF” position to prevent unauthorized uses.
28. **SAVE THESE INSTRUCTIONS.** Refer to them frequently and use them to instruct other users.

SPECIFICATIONS

Motor: 1/3 H.P., 120V, Single Phase
Blade Speed: 3000 SF/M
Table Size: 11-3/8" x 11-3/8"
Table Groove: 1/4 "x 5/8"
Table Tilt: 45° right
Blade Width: 1/8 "minimum / 3/8 "maximum

Blade Length: 59-1/2"
Capacities: Blade to frame 9"
Under Guide 3-3/4"
Height: 29"
Length: 19-1/4"
Width: 12-1/2"
Weight: 33 lbs.

Your new band saw is shipped complete in one container. Carefully unpack the saw and all loose items from the shipping container. Figs. 2 and 3 illustrate the contents of the container.



Fig. 2

- 1 - Band Saw
- 2 - Lamp
- 3 - Lamp cord clamps (2)
- 4 - 1/4" lockwashers (2)
- 5 - M6 x 12mm cheese head screws (2)

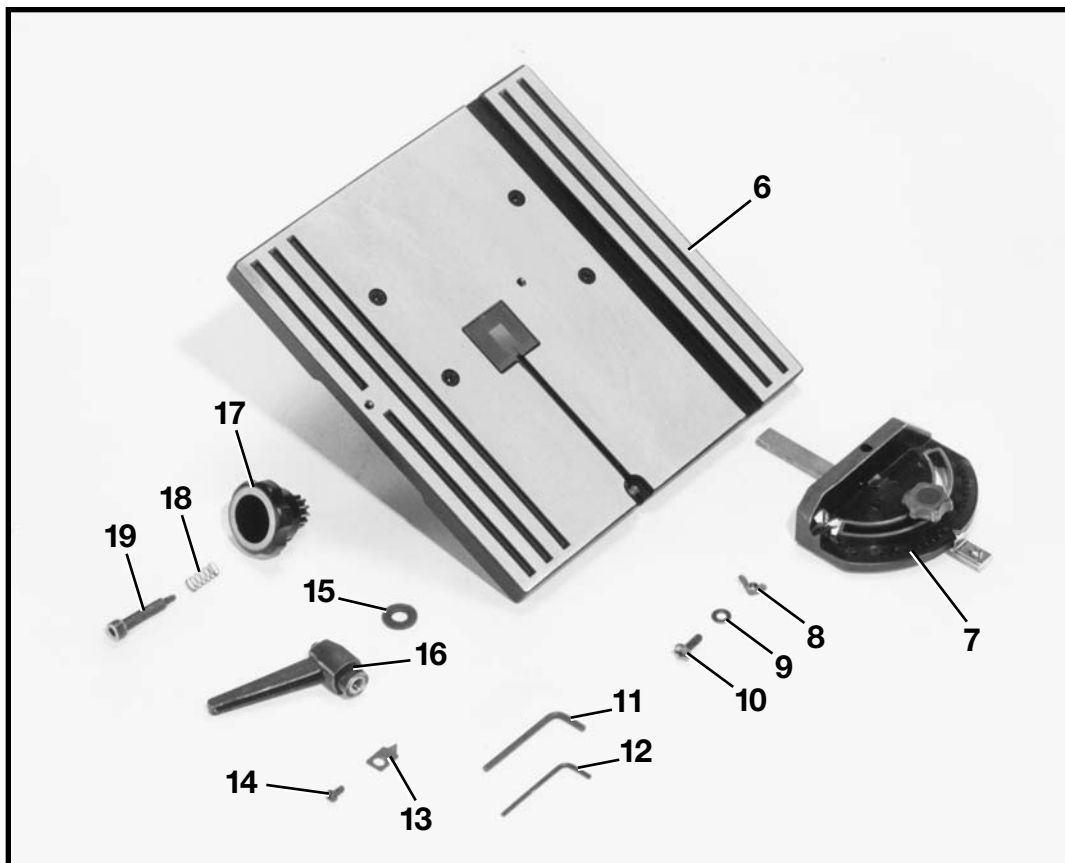

Fig. 3

- 6 - Table
- 7 - Miter gage
- 8 - M6 wing nut
- 9 - Flat washer
- 10 - M6 x 30mm screw
- 11 - 4mm Hex socket wrench
- 12 - 3mm Hex socket wrench
- 13 - Pointer
- 14 - M5 x 10mm screw
- 15 - Flat washer
- 16 - Lever assembly
- 17 - Pinion knob
- 18 - Spring
- 19 - Special screw

ASSEMBLY INSTRUCTIONS

⚠ WARNING: FOR YOUR OWN SAFETY, DO NOT CONNECT THE BAND SAW TO THE POWER SOURCE UNTIL THE MACHINE IS COMPLETELY ASSEMBLED AND YOU HAVE READ AND UNDERSTOOD THE ENTIRE OWNER'S MANUAL.

ASSEMBLING TABLE TO MACHINE

1. Locate table locking lever (shown disassembled) Fig. 4, flat washer (B) and 4mm wrench (C).
2. Using 4mm wrench (C) Fig. 4, supplied, remove screw (D) and spring (E) from handle (A) and remove handle from nut (G). Do not lose spring (E).
3. Place table (H) Fig. 5, onto the band saw frame so that stud (J) Fig. 6, and keepers (K) protrude through the slot of trunnion (L) Fig. 7.
4. While pressing in on stud (M) Fig. 8 with a pencil, place flat washer (B) Fig. 7, onto stud and thread nut (G) onto stud as shown in Fig. 4 and Fig. 7.

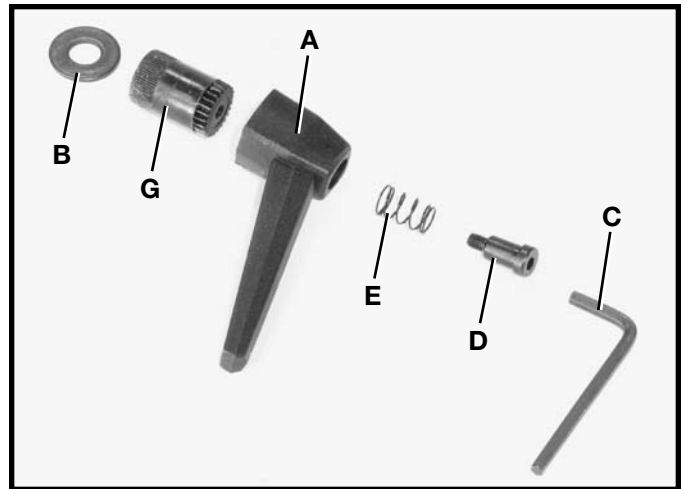

Fig. 4



Fig. 5

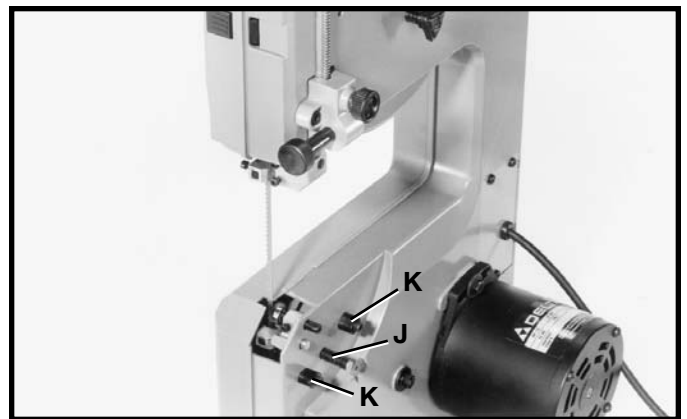

Fig. 6

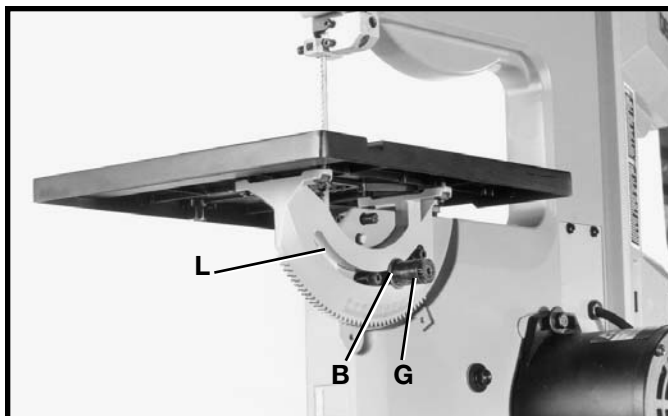

Fig. 7

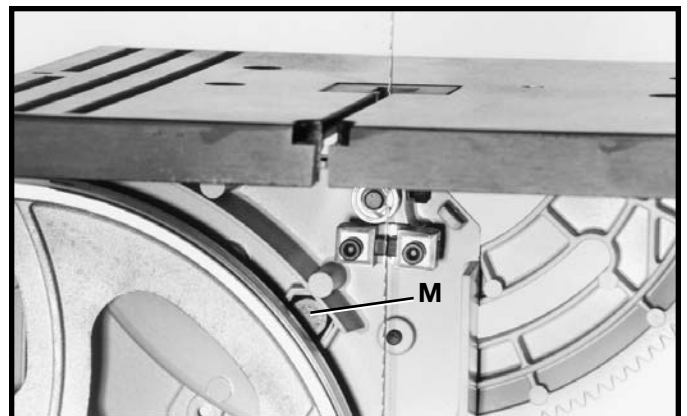

Fig. 8

5. Locate pinion knob (N) Fig. 9, spring (O), and special screw (P).

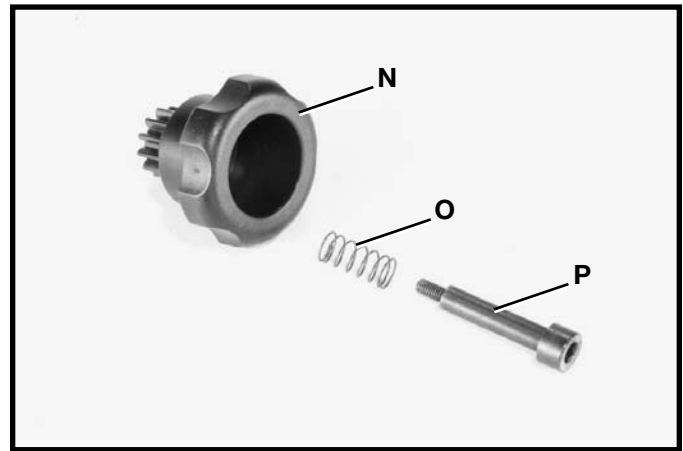

Fig. 9

6. Position pinion knob (N) Fig. 10, onto the back of saw so that the teeth on the pinion knob (N) engage the teeth on the trunnion (R). Fasten in place with special screw (P) and spring using the supplied 4mm wrench.

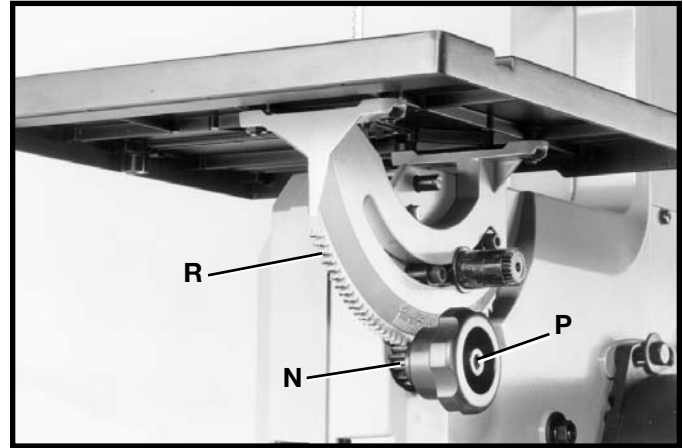

Fig. 10

7. Fasten pointer (S) Fig. 11, to the back of band saw using the M5 x 10mm screw (T).

8. Using the supplied 4mm Hex socket wrench, re-assemble table locking handle (F) Fig. 11, on stud and replace screw and spring (D). **NOTE:** Handle (F) is spring-loaded and can be repositioned on the stud by pulling out the handle and repositioning it on the nut.

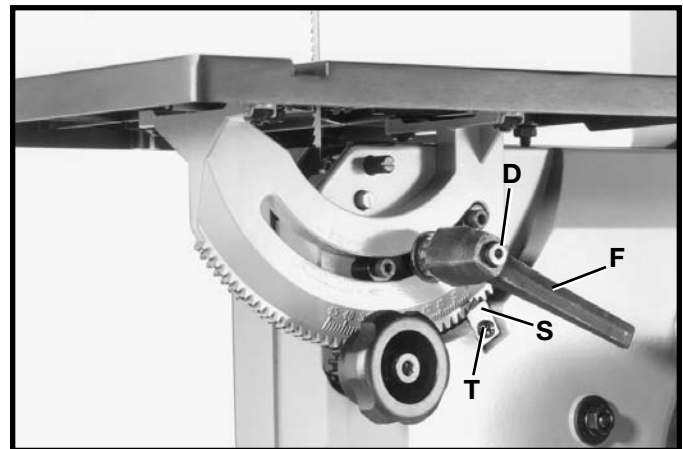

Fig. 11

9. Insert M6 x 30mm screw (W) Fig. 12, down through hole in table, as shown, and fasten in place by using M6 flat washer and M6 wing nut (X).

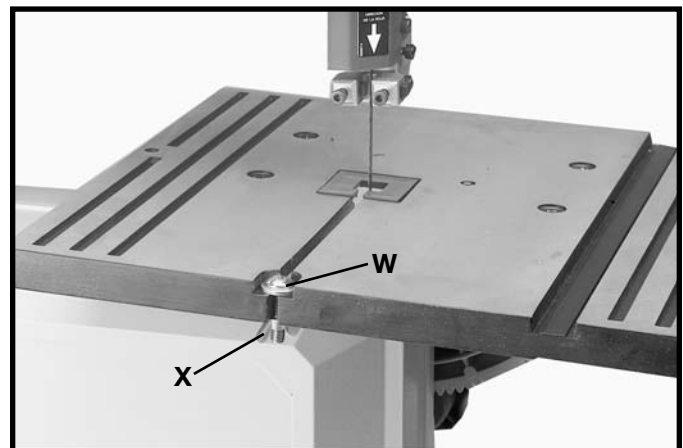

Fig. 12

ASSEMBLING LAMP TO MACHINE

1. Assemble the lamp bracket (A) Fig. 13, to the two holes located on the back top cover of the machine using the two M6 x 12mm screws and 1/4" lockwashers (B) as shown.

2. Peel backing from cord clamps (C) Fig. 13, and apply one clamp at each of the approximate locations shown. Make certain the lamp cord is re-routed out of the way, then secure cord (D) to cord clamps (C) as shown in Fig. 13.

3. The flexible lamp operates independently of the band saw. To turn the lamp on and off, rotate switch (E) Fig. 13. **⚠️WARNING: To reduce the risk of fire, use a 40 watt or less A-15 appliance light bulb (not supplied). A standard household light bulb should not be used.**

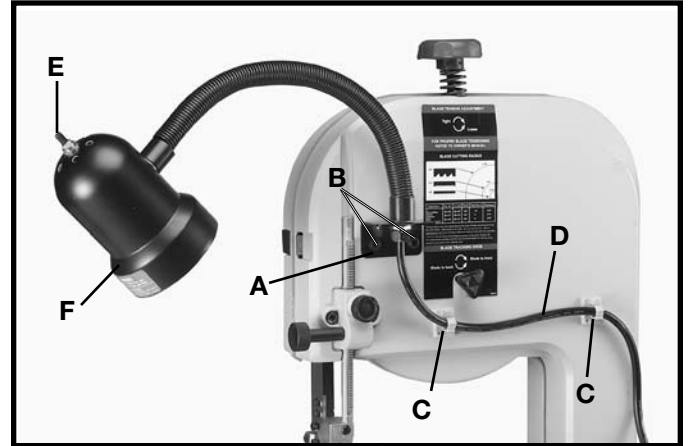

Fig. 13

ASSEMBLING ACCESSORY RIP FENCE TO TABLE

If you purchased the Accessory 28-181 Rip Fence, assemble it to the table as follows:

1. With lever (A) Fig. 14, in the raised position as shown, assemble rear clamp (B) of rip fence (C) over lip of table (D).

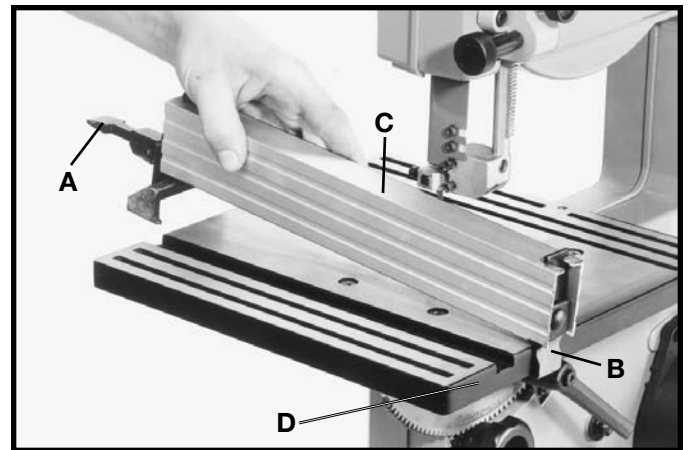

Fig. 14

2. Lower the front of rip fence (C) Fig. 15, against the table and push down on locking lever (A). **NOTE:** Clamping action on the rip fence (C) Fig. 15, can be tightened or loosened by lifting locking lever (A) and rotating lever clockwise or counterclockwise as necessary until firm clamping action is accomplished. Rip fence (C) can be positioned either to the right or left of the saw blade.

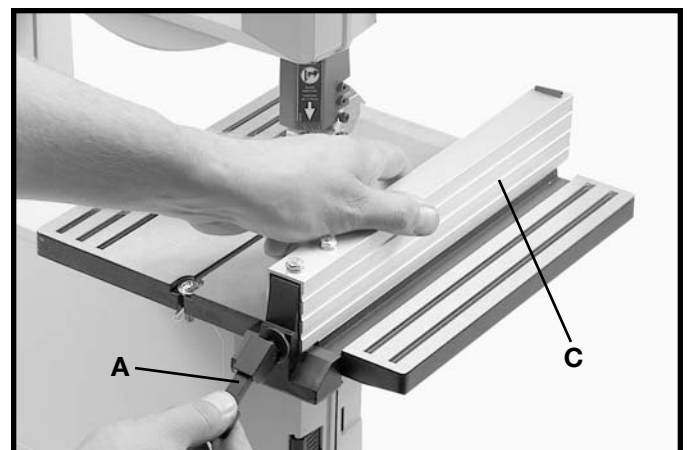

Fig. 15

FASTENING BAND SAW TO SUPPORTING SURFACE

If during operation there is any tendency for the machine to tip over, slide, or “walk” on the supporting surface, the machine must be secured to the supporting surface. Four holes are provided in the band saw base for this purpose, three of which are shown at (A) Fig. 16.



Fig. 16

CONNECTING BAND SAW TO POWER SOURCE

POWER CONNECTIONS

A separate electrical circuit should be used for your tools. This circuit should not be less than #12 wire and should be protected with a 15 Amp fuse. Have a certified electrician replace or repair a worn cord immediately. Before connecting the motor to a power line, make sure the switch is in the “OFF” position and be sure that the electric current is of the same characteristics as stamped on the motor nameplate. Running on low voltage will damage the motor.

⚠ WARNING: DO NOT EXPOSE THE TOOL TO RAIN OR OPERATE THE TOOL IN DAMP LOCATIONS.

MOTOR SPECIFICATIONS

Your band saw is wired for 110-120 volt, 60 Hz alternating current. Before connecting the band saw to the power source, make sure the switch is in the “OFF” position.

EXTENSION CORDS

Use proper extension cords. Make sure your extension cord is in good condition and is a 3-wire extension cord which has a 3-prong grounding type plug and a 3-pole receptacle which will accept the tool’s plug. When using an extension cord, be sure to use one heavy enough to carry the current of the band saw. An undersized cord will cause a drop in line voltage resulting in loss of power and overheating. Fig. 17 shows the correct gage to use depending on cord length. If in doubt, use the next heavier gage. The smaller the gage number, the heavier the cord.

MINIMUM GAUGE EXTENSION CORD			
Ampere Rating	Volts	Total Length of Cord in Feet	Gage of Extension Cord
0-6	120	up to 25	18 AWG
0-6	120	25-50	16 AWG
0-6	120	50-100	16 AWG
0-6	120	100-150	14 AWG
6-10	120	up to 25	18 AWG
6-10	120	25-50	16 AWG
6-10	120	50-100	14 AWG
6-10	120	100-150	12 AWG
10-12	120	up to 25	16 AWG
10-12	120	25-50	16 AWG
10-12	120	50-100	14 AWG
10-12	120	100-150	12 AWG
12-16	120	up to 25	14 AWG
12-16	120	25-50	12 AWG
12-16	120	GREATER THAN 50' NOT RECOMMENDED	
0-6	240	up to 50	18 AWG
0-6	240	50-100	16 AWG
0-6	240	100-200	16 AWG
0-6	240	200-300	14 AWG
6-10	240	up to 50	18 AWG
6-10	240	50-100	16 AWG
6-10	240	100-200	14 AWG
6-10	240	200-300	12 AWG
10-12	240	up to 50	16 AWG
10-12	240	50-100	16 AWG
10-12	240	100-200	14 AWG
10-12	240	200-300	12 AWG
12-16	240	up to 50	14 AWG
12-16	240	50-100	12 AWG
12-16	240	GREATER THAN 100' NOT RECOMMENDED	

Fig. 17

GROUNDING INSTRUCTIONS

CAUTION: THIS TOOL MUST BE GROUNDED WHILE IN USE TO PROTECT THE OPERATOR FROM ELECTRIC SHOCK.

In the event of a malfunction or breakdown, grounding provides a path of least resistance for electric current to reduce the risk of electric shock. This tool is equipped with an electric cord having an equipment-grounding conductor and a grounding plug. The plug must be plugged into a matching outlet that is properly installed and grounded in accordance with all local codes and ordinances.

Do not modify the plug provided - if it will not fit the outlet, have the proper outlet installed by a qualified electrician.

Improper connection of the equipment-grounding conductor can result in risk of electric shock. The conductor with insulation having an outer surface that is green with or without yellow stripes is the equipment-grounding conductor. If repair or replacement of the electric cord or plug is necessary, do not connect the equipment grounding conductor to a live terminal.

Check with a qualified electrician or service personnel if the grounding instructions are not completely understood, or if in doubt as to whether the tool is properly grounded.

Use only 3-wire extension cords that have 3-prong grounding types plugs and 3-hole receptacles that accept the tool's plug, as shown in Fig. 18.

Repair or replace damaged or worn cord immediately.

This tool is intended for use on a normal 120-volt circuit and has a grounded plug that looks like the plug illustrated in Fig. 18.

If a properly grounded outlet is not available, a temporary adapter, shown in Fig. 19, may be used for connecting the 3-prong grounding type plug to a 2-prong receptacle. The temporary adapter should be used only until a properly grounded outlet can be installed by a qualified electrician. **THIS ADAPTER IS NOT APPLICABLE IN CANADA.** The green colored rigid ear, lug, or the like extending from the adapter must be connected to a permanent ground such as a properly grounded outlet box cover. Whenever the adapter is used, it must be held in place with a metal screw.

⚠️WARNING: IN ALL CASES, MAKE CERTAIN THE RECEPTACLE IN QUESTION IS PROPERLY GROUNDED. IF YOU ARE NOT SURE, HAVE A CERTIFIED ELECTRICIAN CHECK THE RECEPTACLE.

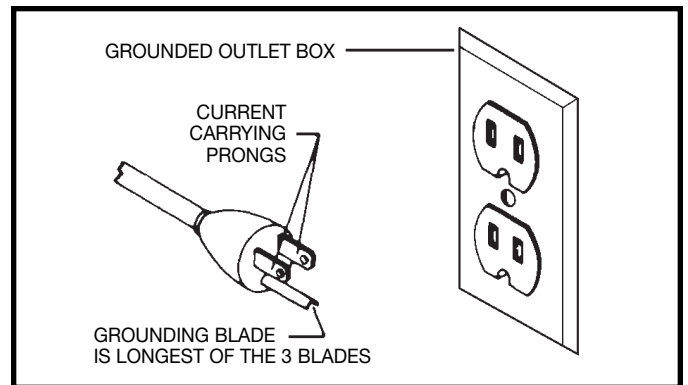

Fig. 18

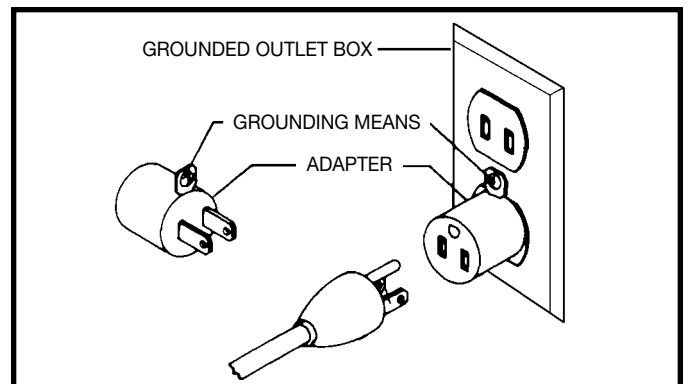

Fig. 19

OPERATING CONTROLS AND ADJUSTMENTS

STARTING AND STOPPING SAW

The switch (A) Fig. 20, is located on the front side of the band saw. To turn the saw “ON” move the switch (A) to the up position. To turn the saw “OFF” move the switch (A) to the down position.

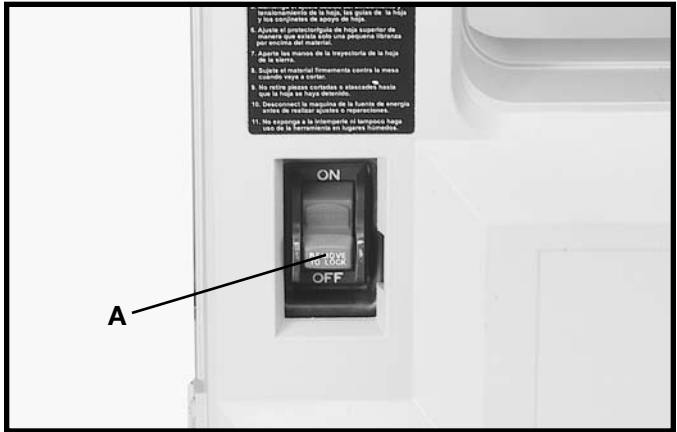

Fig. 20

LOCKING SWITCH IN THE “OFF” POSITION

When the tool is not in use, the switch be locked in the “OFF” position. This can be done by grasping the switch toggle (B) Fig. 21, and pulling it out of the switch, as shown. With the switch toggle (B) removed, the switch will not operate. However, should the switch toggle be removed while the machine is running, the switch can be turned “OFF” once, but cannot be restarted without inserting the switch toggle (B).

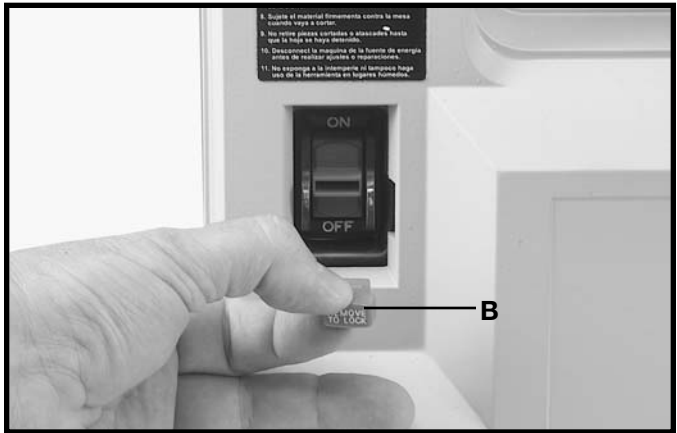

Fig. 21

OPENING AND CLOSING HINGED DOOR

For the purpose of making adjustments such as changing the blade, tracking the blade, blade guide adjustments, etc., the hinged door (B) Figs. 22 and 23, must be opened as follows:

1. **CAUTION: NEVER OPEN THE HINGED DOOR WHEN THE MACHINE IS RUNNING.**
2. Press in the two locking latches (A) Fig. 22, and swing door (B) open.
3. Fig. 23, illustrates door (B) in open position.
4. To close and fasten door (B) Figs. 22 and 23, press on door directly over latches (A) Fig. 22, until latches snap into the locking position.

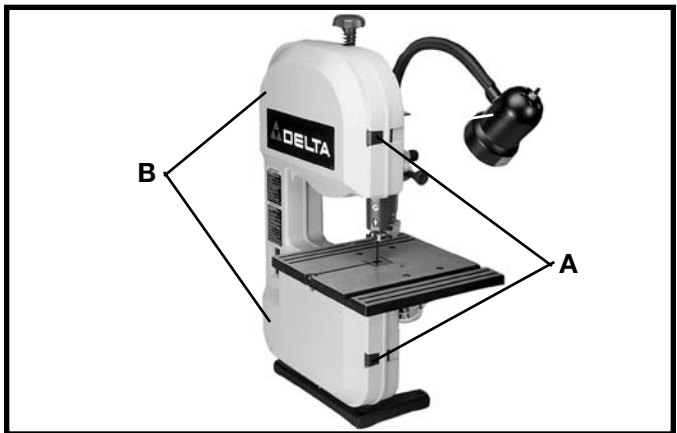

Fig. 22

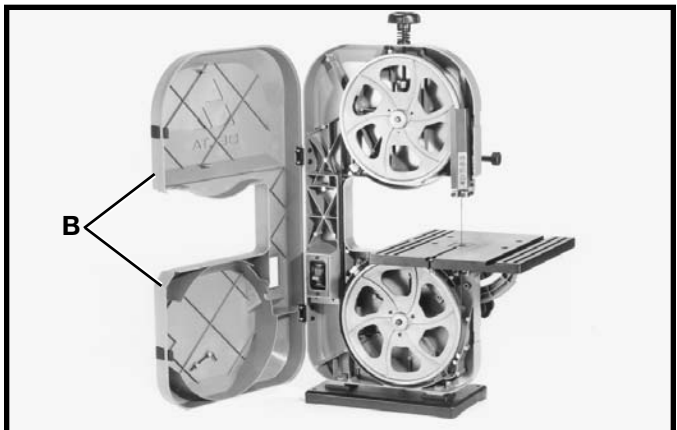

Fig. 23

ADJUSTING BLADE TENSION

Blades of 1/8", 1/4", and 3/8" wide by 59-1/2" in length are available for use with your band saw. **NOTE:** The blade tension must be adjusted to accommodate different blade widths in order to provide proper blade tracking, cutting performance and blade life.

1. **DISCONNECT THE MACHINE FROM THE POWER SOURCE.**
2. After the desired blade is assembled to the two band saw wheels, turn tension knob (A) Fig. 24, clockwise until spring (B) begins to compress.
3. Turn tension knob (A) Fig. 24, an additional 2-1/2 complete turns for 1/8" wide blades; 3 complete turns for 1/4" wide blades; and 4 complete turns for 3/8" wide blades.
4. There is a convenient chart (C) Fig. 24, at the rear of the band saw displaying blade choice and the minimum radius which can be cut with each blade.

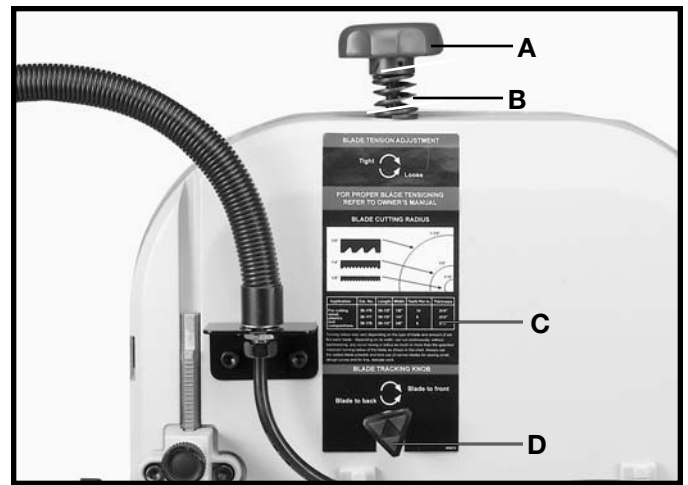

Fig. 24

TRACKING THE BLADE

1. **DISCONNECT THE MACHINE FROM THE POWER SOURCE.**
2. Before tracking the blade, make sure the blade guides and blade support bearings are clear of the blade so as not to interfere with the tracking adjustment. Also make sure that the blade is tensioned properly. (Refer to section "ADJUSTING BLADE TENSION").
3. Rotate upper wheel (A) Fig. 25, clockwise by hand and check to see if the blade (B) rides true on the approximate center of the two wheels.
4. If an adjustment is necessary, **SLIGHTLY** turn blade tracking knob (D) Fig. 24, clockwise to move the blade to the rear, and counterclockwise to move the blade to the front. **NOTE:** Very little movement of the blade tracking adjusting knob (D) is necessary to permit the blade to move.

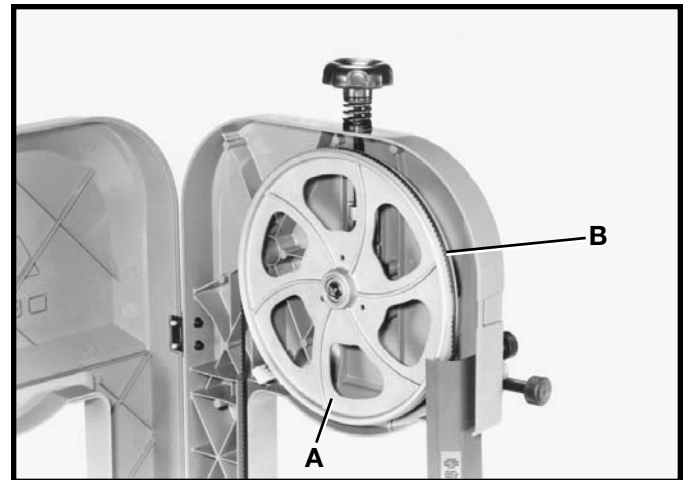

Fig. 25

ADJUSTING UPPER BLADE GUIDE ASSEMBLY

The upper blade guide assembly (A) Fig. 26, should always be no more than 1/4" above or as close as possible to the top surface of the workpiece being cut. Loosen knob (B) Fig. 26, rotate knob (C) and position the guide assembly (A) to the desired position. Then tighten knob (B).

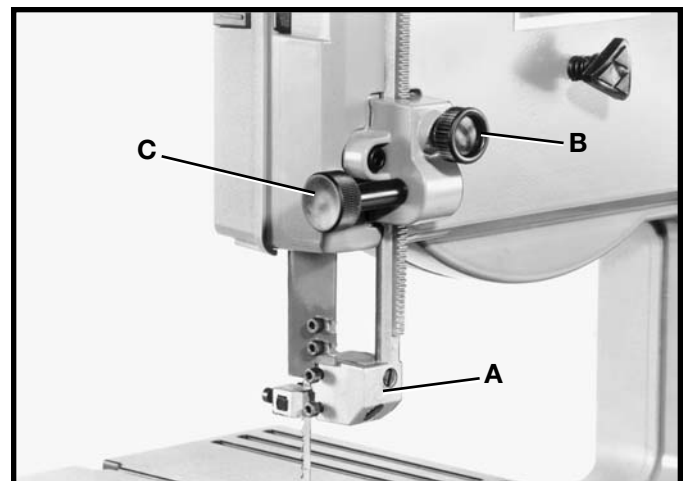

Fig. 26

ADJUSTING UPPER BLADE GUIDES AND BLADE SUPPORT BEARING

IMPORTANT: BOTH THE UPPER AND LOWER BLADE GUIDES MUST BE PROPERLY ADJUSTED TO PREVENT THE BLADE FROM TWISTING DURING OPERATION.

1. **DISCONNECT THE MACHINE FROM THE POWER SOURCE.**
2. **NOTE:** Upper blade guard (B) Fig. 27, is shown removed for clarity.
3. Loosen the two screws (C) Fig. 27, and adjust the blade guides (D) as close as possible to the sides of the saw blade, being careful not to pinch the blade. Then tighten the two screws (C).
4. Loosen screw (E) Fig. 27, and move the guide bracket (F) in or out until the front edge of the guides (D) is just behind the "gullets" of the blade teeth. Then tighten screw (E).

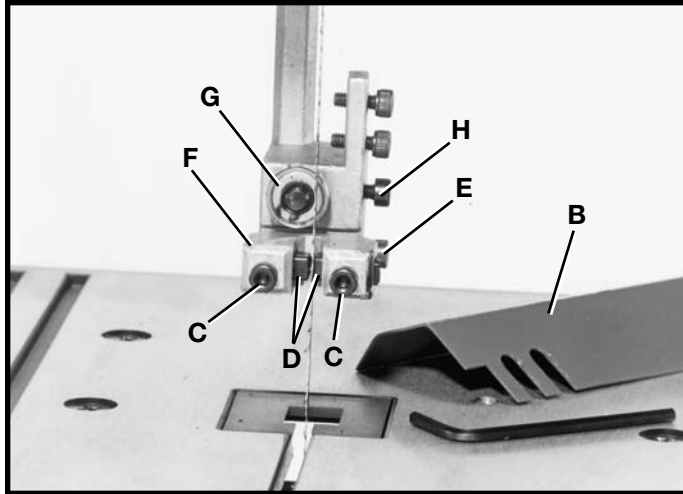

Fig. 27

5. The upper blade support/thrust bearing (G) Fig. 27, prevents the saw blade from being pushed back too far when cutting. The support bearing (G) should be adjusted approximately 1/32" behind the rear edge of the blade, so the back edge of the blade overlaps the outside diameter of the ball bearing by approximately 1/8". To adjust, proceed as follows:

6. **DISCONNECT THE MACHINE FROM THE POWER SOURCE.**
7. Loosen screw (H) Fig. 27, and slide support bearing (G) in or out until it is approximately 1/32" behind the rear edge of the saw blade. Then tighten screw (H).
8. The upper blade support bearing (G) Fig. 27, is set on an eccentric shaft. To change position of bearing (G), loosen screw (H) Fig. 27, and using a straight screwdriver, rotate shaft (J) Fig. 28, until the blade properly overlaps the support bearing. Then tighten screw (H).

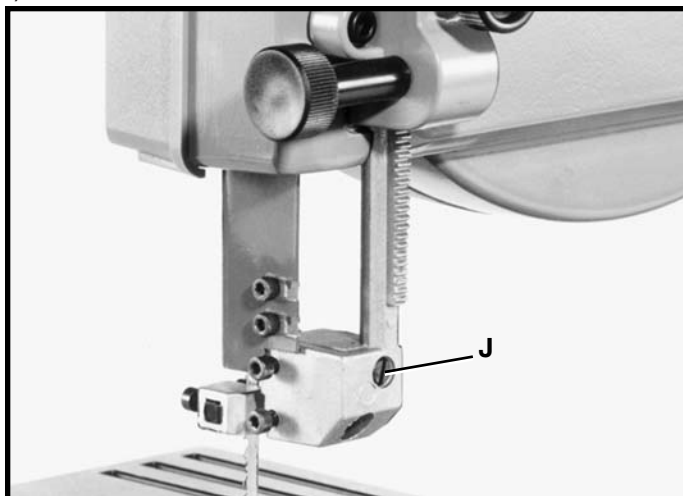

Fig. 28

ADJUSTING LOWER BLADE GUIDES AND BLADE SUPPORT BEARING

The lower blade guides and blade support bearing should be adjusted at the same time as the upper guides and support bearings as follows:

1. **DISCONNECT THE MACHINE FROM THE POWER SOURCE.**

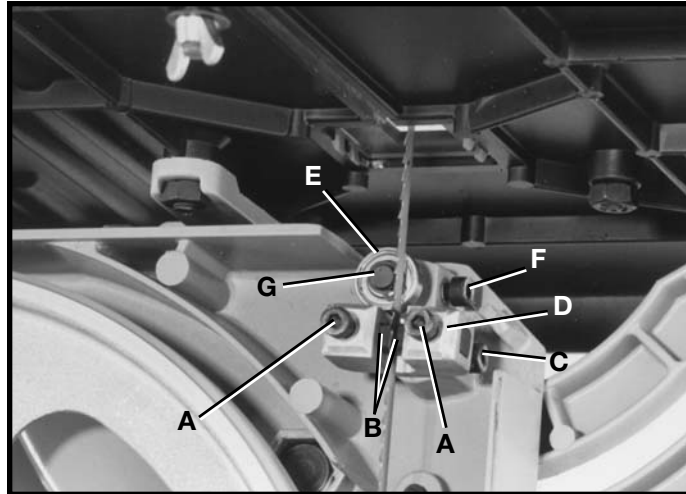

Fig. 29

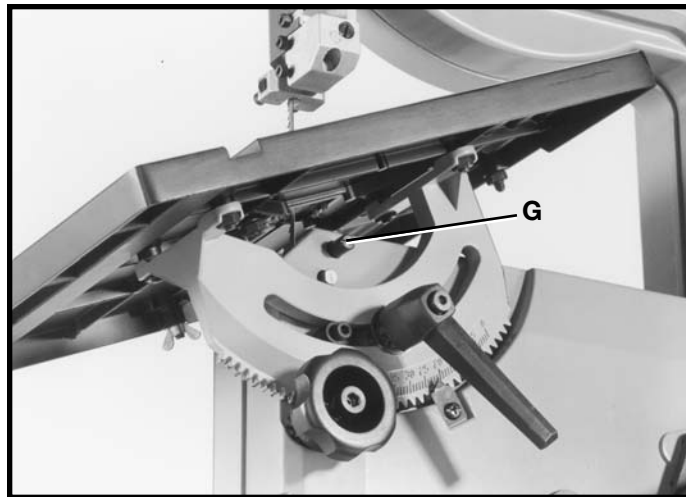

Fig. 30

2. Loosen two screws (A) Fig. 29, and move guides (B) as close as possible to the sides of the blade, being careful not to pinch the blade between the guides. Then tighten two screws (A).
3. The front edge of guide blocks (B) Fig. 29, should be adjusted so they are just behind the “gullets” of the blade teeth by loosening screw (C), and moving assembly (D) in or out as necessary. Then tighten screw (C).
4. The lower blade support bearing (E) Fig. 29, should be adjusted to support the rear of the blade during the cutting operation and also prevent the blade from being pushed too far to the rear which could damage the blade teeth. The support bearing (E) Fig. 29, should be set about 1/32" behind the blade by loosening screw (F) Fig. 29, and moving shaft (G) in or out. Then tighten screw (F).
5. The lower blade support bearing (E) Fig. 29, should also be adjusted so the back edge of the blade overlaps the outside diameter of the ball bearing by approximately 1/8". The blade support bearing (E) is set on an eccentric shaft. To change position of bearing (E), loosen screw (F) Fig. 29, and rotate shaft (G) Figs. 29 and 30, using a straight screwdriver until the blade properly overlaps the support bearing. Then tighten screw (F) Fig. 29.

TILTING THE TABLE

1. The table can be tilted 45 degrees to the right. To tilt the table, loosen lock handle (A) Fig. 31, and turn knob (B) clockwise until desired angle is established. Then tighten lock handle (A). **NOTE:** The table lock handle (A) can be repositioned by pulling out on the handle and repositioning it on the nut located underneath the hub of the handle. A scale (C) and pointer (D) are provided to indicate the degree of tilt.

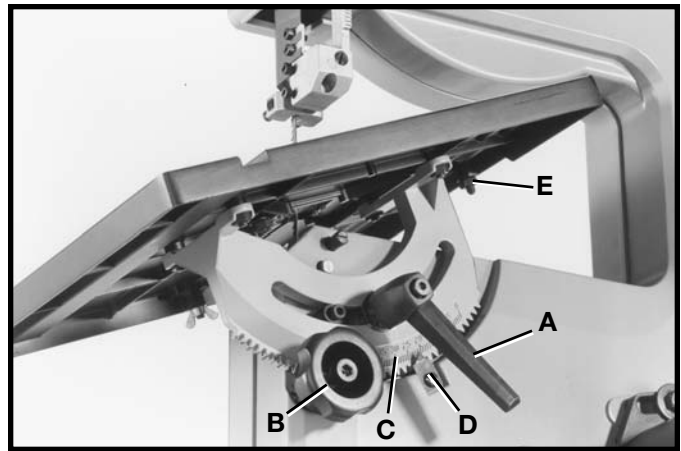

Fig. 31

ADJUSTING THE TABLE POSITIVE STOPS

Positive stops are provided for the table at the 90 and 45 degree angle to the blade. To check and adjust the positive stops, proceed as follows:

MAKE CERTAIN THE MACHINE IS DISCONNECTED FROM THE POWER SOURCE.

1. Tilt the table to the 90 degree position as shown in Fig. 32, and tighten lock handle (A) Fig. 31. Place a square (B) Fig. 32, on the table and against the blade and check to see if the blade is 90 degrees to the table surface. If an adjustment is necessary, proceed as follows:

2. Tilt the table slightly as shown in Fig. 31, to expose lock nut (E). Loosen lock nut and return table to the 90° position. With the lock handle (A) loose, turn adjusting screw (F) Fig. 32, using the wrench (G) provided until the blade is 90 degrees to the table. Then tighten lock nut (E) Fig. 32, and lock handle (A).

3. Tilt the table to the 45 degree position as shown in Fig. 33. Place a square (H) on the table and against the blade and check to see if the blade is 45 degrees to the table surface. If an adjustment is necessary, proceed as follows:

4. Loosen lock nut on adjustment screw (J) Fig. 33, located on the underside of the table. With lock handle (A) Fig. 33, loose, turn adjustment screw (J) using wrench (G) provided until the blade is 45 degrees to the table. Then tighten lock handle (A), and lock nut on adjustment screw (J).

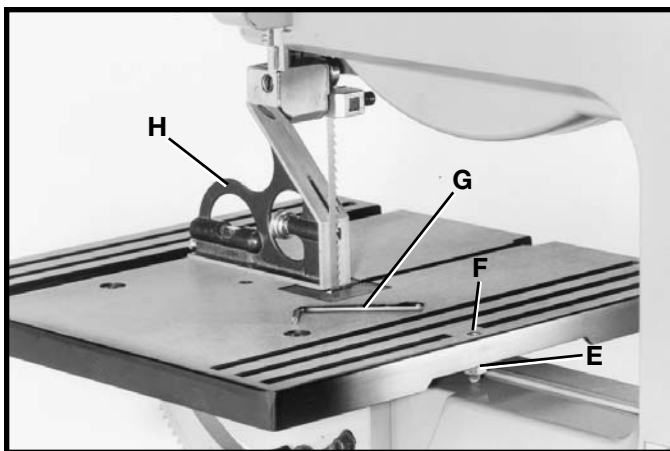

Fig. 32

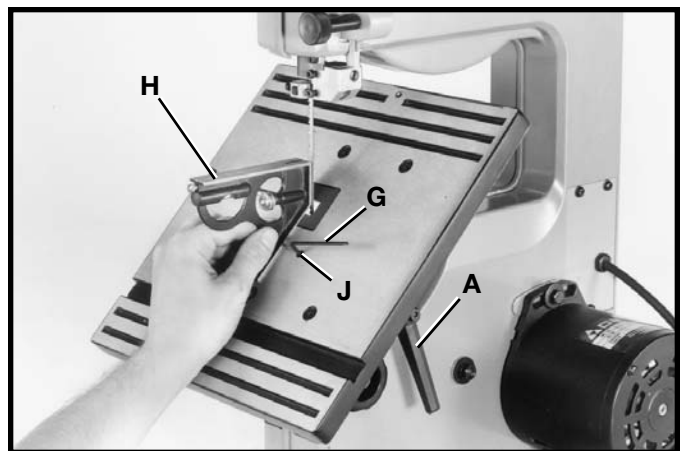

Fig. 33

ADJUSTING BELT TENSION

If the drive belt on your band saw needs adjustment, proceed as follows:

1. DISCONNECT SAW FROM THE POWER SOURCE.

2. The belt (A) Fig. 34, drives the saw pulley from the motor pulley. Correct tension of the belt (A) is when there is approximately 1/4" deflection in the center span of the belt (A) using light finger pressure. If belt tension needs adjusted, loosen two screws (B) Fig. 35, and rotate motor accordingly. Tighten screws (B) when adjustment is completed.

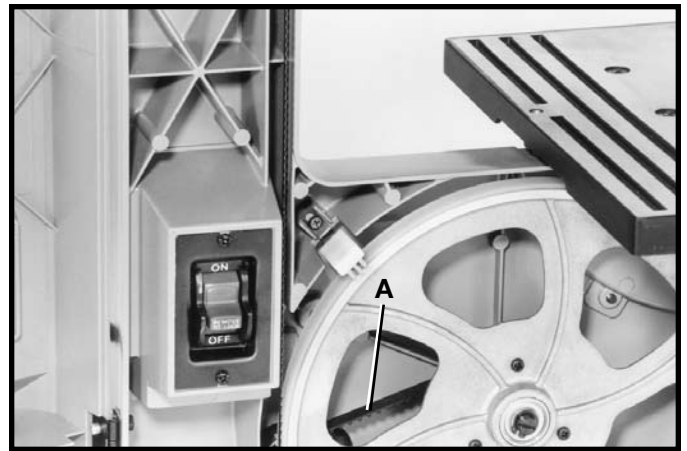

Fig. 34

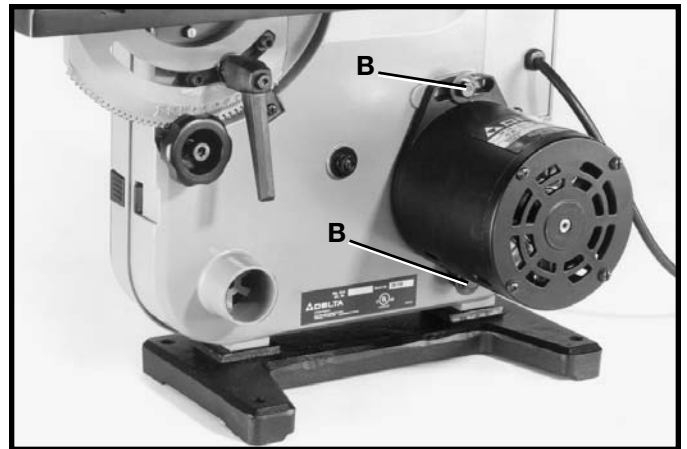

Fig. 35

WHEEL BRUSHES

1. DISCONNECT SAW FROM THE POWER SOURCE.

1. Two wheel brushes (A) Fig. 36, are provided on the machine to keep the tires free of any build-up of wood chips. Adjustments can be made by loosening screws, one of which is shown at (B) (which secure the brushes to the machine) and adjusting brushes accordingly. Then tighten screws (B).

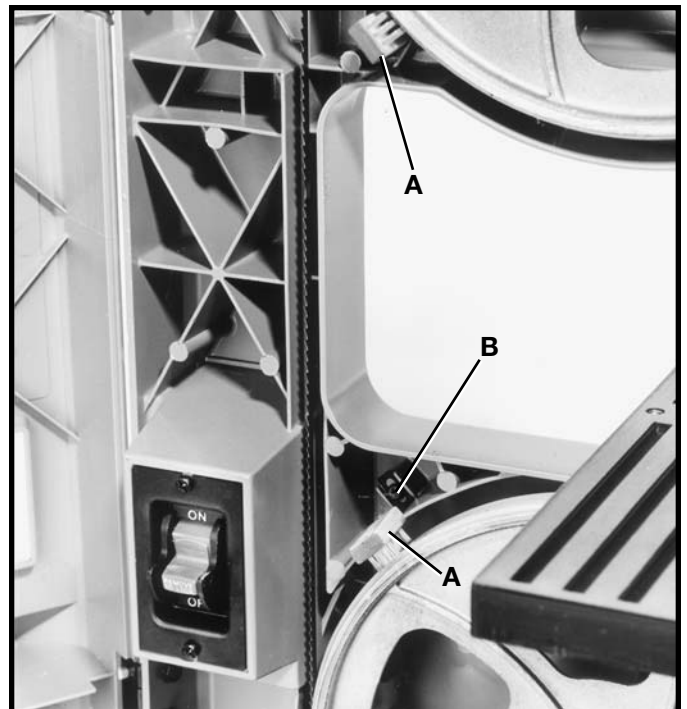

Fig. 36

WRENCH STORAGE

The 3mm and 4mm adjustment wrenches (A) supplied with your band saw can be conveniently stored inside the wheel cover as shown in Fig. 37.

MITER GAGE

A miter gage (A) Fig. 38, is supplied with your band saw. The miter gage body (C) can be adjusted up to 45 degrees right and left, by loosening lock knob (B), rotating miter gage body (C) to the desired angle, and tightening lock knob (B).

BLADE CHANGING

To change blades, proceed as follows:

1. **DISCONNECT SAW FROM THE POWER SOURCE.**
2. Press in door latches (A) Fig. 39, and open door (B) as shown.
3. Loosen two screws (C) Fig. 40, and remove blade guard (D).
4. Release tension on the band saw blade by turning tension knob (E) Fig. 39 counterclockwise.
5. Remove table alignment screw (F) Fig. 41.
6. Slip the blade off both wheels and guide it out through the slot in the table.
7. Check the new blade to determine that the teeth will point down toward the table when installed. **IF NOT, CAREFULLY TURN BLADE INSIDE OUT.**
8. Place the new blade onto wheels and adjust blade tension, blade guides and tracking as described previously in this manual.
9. Replace blade guard, which was removed in **STEP 3**, and table alignment screw which was removed in **STEP 5**.
10. Close door (B) Fig. 39, before operating saw.

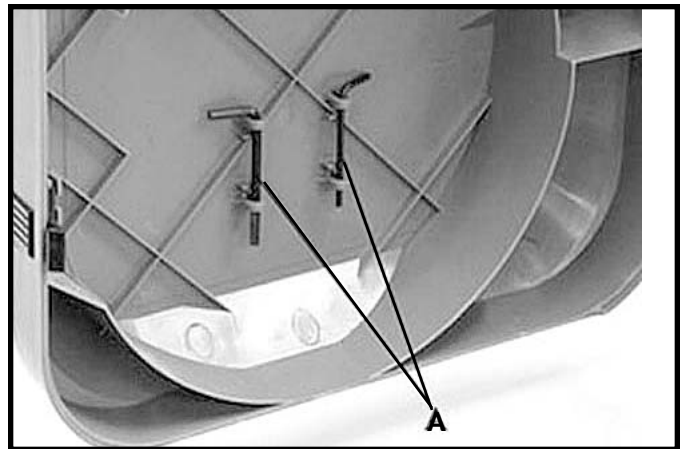

Fig. 37

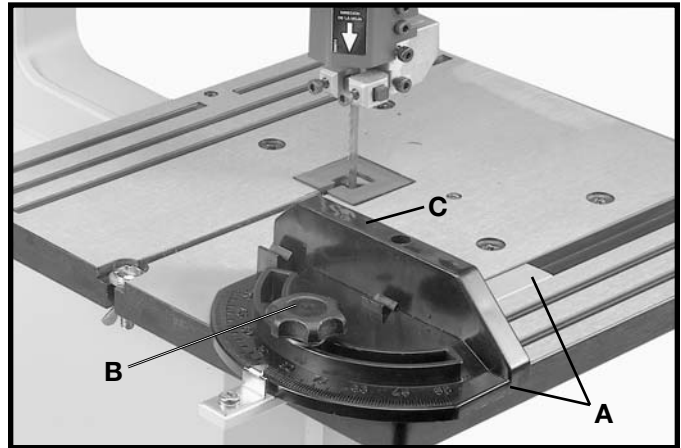

Fig. 38

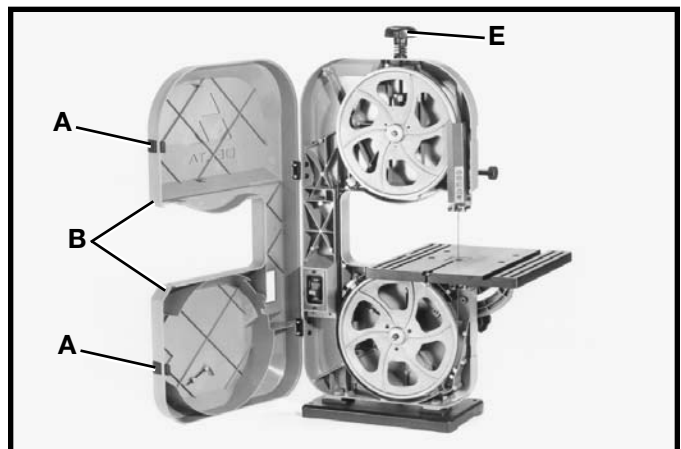

Fig. 39

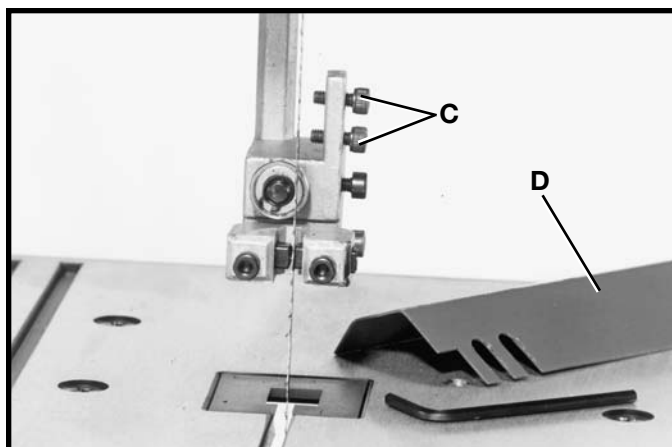

Fig. 40

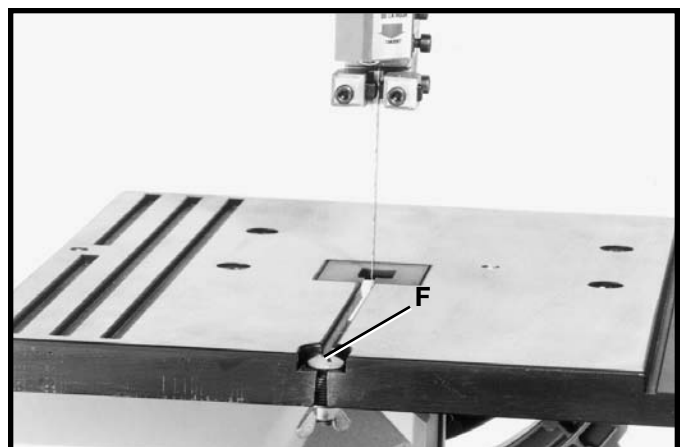

Fig. 41

ACCESSORY RIP FENCE OPERATION AND ADJUSTMENTS

The accessory rip fence (A) Fig. 42, can be moved along the table surface by lifting lock lever (B) and sliding the rip fence (A) to the desired location on the table. Push down on lever (B) to firmly lock rip fence in position on the table. When the rip fence (A) is locked to the band saw table, it should be parallel to the miter gage slot (D). If an adjustment is necessary, proceed as follows:

1. **DISCONNECT MACHINE FROM THE POWER SOURCE.**
2. Loosen two screws (E) Fig. 42, and raise locking lever (B).
3. While holding rip fence bracket (F) Fig. 42 firmly, move the far end of the fence (A) until it is parallel with the miter gage slot (D).
4. Tighten two screws (E) Fig. 42, and push down on locking lever (B).
5. Clamping action on the rip fence (A) Fig. 42, can be tightened or loosened by lifting locking lever (B) and rotating lever (B) clockwise or counterclockwise as necessary.

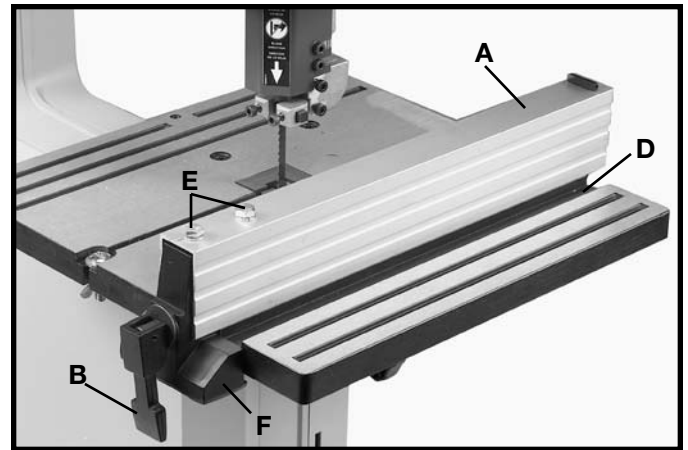

Fig. 42

DUST CHUTE

A built-in dust chute (A) Fig. 43, on your bench band saw is equipped with a 1-1/2" I.D. opening that can easily be connected to a dust collection system.

IDENTIFICATION PLATE

The identification plate (B) Fig. 43, is located at the rear of the machine near the motor. The Model No. and Serial No. are located on this plate. Please write these numbers on the front cover of this manual for future reference.

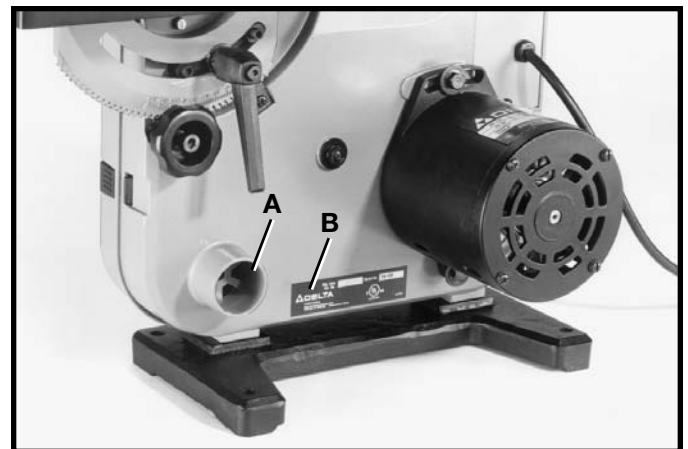

Fig. 43

OPERATING THE BAND SAW

Before starting the machine, see that all adjustments are properly made and the guards are in place. Turn the upper wheel by hand to make sure that everything is correct **BEFORE** turning on the power.

Keep the top guide down close to the work at all times. Do not force the material against the blade too hard. Light contact with the blade will permit easier following of the line and prevent undue friction, heating and work-hardening of the blade at its back edge.

KEEP THE SAW BLADE SHARP and you will find that very little forward pressure is required for average cutting. Move the stock against the blade steadily and no faster than will give an easy cutting movement.

Avoid twisting the blade by trying to turn sharp corners. Remember, you must saw around corners.

CUTTING CURVES

When cutting curves, turn the stock carefully so that the blade follows without twisting. If a curve is so abrupt that it is necessary to repeatedly back up and cut a new kerf, a narrower blade, a blade with more set, or additional relief cuts Fig. 44, may be necessary to allow the blade to cut more efficiently. The more set a blade has, the easier it will allow the stock to be turned, but the cut is usually rougher than where a medium amount of set is used.

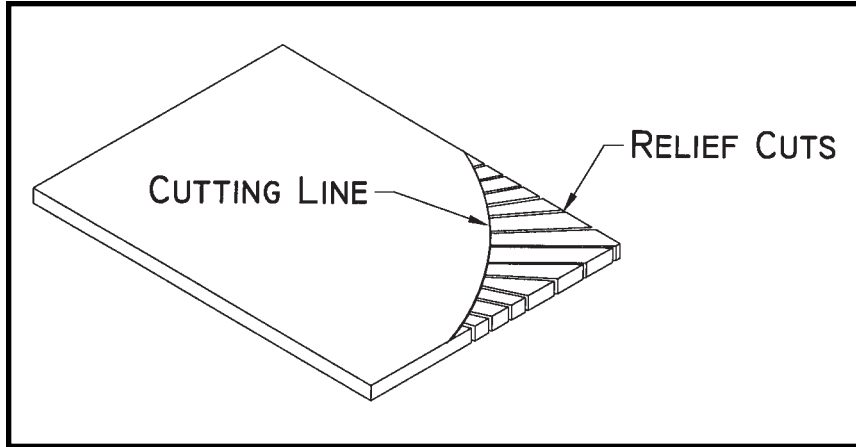

Fig. 44

In withdrawing the piece being cut, in order to change the cut, or for any other reason, the operator must be careful that he does not accidentally draw the blade off the wheels. In most cases, it is easier and safer to turn the stock and saw out through the waste material, rather than try to withdraw the stock from the blade.

OPERATIONS



Fig. 45

Fig. 45 illustrates a typical cross-cutting operation using a miter gage. Notice how the upper blade guide (A) assembly is set slightly above the work surface (B).



Fig. 46

Fig. 46 illustrates a typical bevel cutting operation using a miter gage.



Fig. 47

Fig. 47 illustrates a typical resawing application using the accessory rip fence.

TROUBLESHOOTING GUIDE

In spite of how well a band saw is maintained, problems can occur. The following troubleshooting guide will help you solve the more common problems:

Trouble: *SAW WILL NOT START.*

Probable Cause

1. Saw not plugged in.
2. Fuse blown or circuit breaker tripped.
3. Cord damaged.

Remedy

1. Plug in saw.
2. Replace fuse or reset circuit breaker.
3. Have cord replaced.

Trouble: *BREAKER KICKS OUT FREQUENTLY.*

Probable Cause

1. Extension cord too light or too long.
2. Feeding stock too fast.
3. Blade in poor condition (dull, warped, gummed).
4. Low voltage supply.

Remedy

1. Replace with adequate size cord.
2. Feed stock more slowly.
3. Clean or replace blade.
4. Contact your electric company.

Trouble: *BAND SAW VIBRATES EXCESSIVELY.*

Probable Cause

1. Machine not mounted securely to workbench.
2. Bench on uneven floor.
3. Irregular belt.
4. Belt not tensioned correctly.
5. Motor not fastened securely.

Remedy

1. Tighten all mounting hardware.
2. Reposition on flat level surface.
3. Replace belt.
4. Adjust belt tension by moving motor.
5. Tighten all mounting hardware.

Trouble: *BAND SAW DOES NOT COME UP TO SPEED.*

Probable Cause

1. Extension cord too light or too long.
2. Low supply voltage.

Remedy

1. Replace with adequate size cord.
2. Contact your electric company.

Trouble: *BLADES BREAK.*

Probable Cause

1. Blade not tensioned properly.
2. Blade guides improperly adjusted.
3. Blade support bearing improperly adjusted.
4. Blade wheel tracking adjustment improperly set.
5. Bad weld on blade.
6. Worn tires.
7. Forcing wide blade around short radius.
8. Dull blade or insufficient set.
9. Upper blade guide set too high.
10. Continuous running of machine when not actually cutting.

Remedy

1. Adjust blade tension.
2. Check and adjust blade guides.
3. Adjust blade support bearing.
4. Check and adjust blade tracking.
5. Replace the blade.
6. Replace tires.
7. Change to a narrower blade.
8. Replace blade.
9. Set upper blade guide as close as possible to work.
10. Turn off machine when not performing cutting operation.

(continued on next page)

TROUBLESHOOTING GUIDE

(CONTINUED)

Trouble: *BLADE WILL NOT TRACK.*

Probable Cause

1. Blade too loose
2. Upper wheel not properly adjusted.
3. Improper back-up bearing adjustment.

Remedy

1. Adjust tension
2. Adjust upper wheel.
3. Adjust back-up.

Trouble: *CUT DOES NOT AGREE WITH SETTING ON THE TILT SCALE.*

Probable Cause

1. Pointer out of adjustment

Remedy

1. Adjust pointer.

Trouble: *BLADE WILL NOT STAY ON WHEEL.*

Probable Cause

1. Blade not tensioned properly.
2. Blade guides improperly adjusted.
3. Blade support bearing improperly adjusted.
4. Blade wheel tracking adjustment improperly set.
5. Bad weld on blade.
6. Worn tires.

Remedy

1. Adjust blade tension.
2. Check and adjust blade guides.
3. Adjust blade support bearing.
4. Check and adjust blade tracking.
5. Replace the blade.
6. Replace tires.

Trouble: *BAND SAW MAKES UNSATISFACTORY CUTS.*

Probable Cause

1. Blade not tensioned properly.
2. Blade guides improperly adjusted.
3. Blade support bearing improperly set.
4. Blade wheel tracking adjustment improperly set.
5. Bad weld on blade.
6. Worn tires.
7. Incorrect blade for work being done.
8. Dull blade or insufficient set.
9. Upper blade guide set too high.
10. Continuous running of machine when not actually cutting.

Remedy

1. Adjust blade tension.
2. Check and adjust blade guides.
3. Adjust blade support bearing.
4. Check and adjust blade tracking.
5. Replace the blade.
6. Replace tires.
7. Change the blade.
8. Replace blade.
9. Set upper blade guide as close as possible to work.
10. Turn off machine when not performing cutting operation.

BAND SAW BLADES

A band saw blade is a delicate piece of steel that is subjected to tremendous strain. You can obtain long use from a band saw blade if you give it fair treatment. Be sure you use blades of the proper thickness, width and temper for the various types of material to be cut.

Always use the widest blade possible. Use the narrow blades only for sawing small, abrupt curves and for fine, delicate work. This will save blades and will produce better work. Band saw blades may be purchased, welded, set and sharpened ready for use. For cutting wood and similar materials, Delta can supply blades in widths of 1/8, 1/4, and 3/8 inches.

Any one of a number of conditions may cause a band saw blade to break. Blade breakage is, in some cases, unavoidable, being the natural result of the peculiar stresses to which such blades are subjected. It is, however, often due to avoidable causes, most often to lack of care or judgment on the part of the operator in mounting or adjusting the blade or guides. The most common causes of blade breakage are:

- (1) faulty alignments and adjustments of the guides;
- (2) forcing or twisting a wide blade around a curve of short radius;
- (3) feeding too fast;
- (4) dullness of the teeth or absence of sufficient set;
- (5) excessive tensioning of the blade;
- (6) top guide set too high above the work being cut;
- (7) using a blade with a lumpy or improperly finished braze or weld; and
- (8) continuous running of the saw blade when not in use for cutting.

Blades for the new 28-150 9" Band Saw are 59-1/2 inches long.

Always use a sharp blade. Keep it free from gum and pitch. Clean frequently with a stiff fiber brush.

Narrow blades are used for cutting small circles or curves while the wider blades are best suited for straight cutting such as ripping.

Due to the low cost of blades, it is advisable to purchase new blades rather than attempt to have them sharpened.

Make sure the blade guides are always adjusted properly as previously outlined.

Do not force or twist the blade around a curve or a very short radius.

Feed the work uniformly, allowing the blade to cut – do not feed too fast.

Do not apply excessive tension on blades. The tension is only necessary to drive the blade without slipping on the wheels. Narrow blades require less tension than wider blades.

NOTES



All Delta Machines and accessories are manufactured to high quality standards and are serviced by a network of Porter-Cable•Delta Factory Service Centers and Delta Authorized Service Stations. To obtain additional information regarding your Delta quality product or to obtain parts, service, warranty assistance, or the location of the nearest service outlet, please call 1-888-848-5175 (In Canada call 1-800-463-3582).



Delta Building Trades and Home Shop Machinery Two Year Limited Warranty

Delta will repair or replace, at its expense and at its option, any Delta machine, machine part, or machine accessory which in normal use has proven to be defective in workmanship or material, provided that the customer returns the product prepaid to a Delta factory service center or authorized service station with proof of purchase of the product within two years and provides Delta with reasonable opportunity to verify the alleged defect by inspection. Delta may require that electric motors be returned prepaid to a motor manufacturer's authorized station for inspection and repair or replacement. Delta will not be responsible for any asserted defect which has resulted from normal wear, misuse, abuse or repair or alteration made or specifically authorized by anyone other than an authorized Delta Service facility or representative. Under no circumstances will Delta be liable for incidental or consequential damages resulting from defective products. This warranty is Delta's sole warranty and sets forth the customer's exclusive remedy, with respect to defective products; all other warranties, express or implied, whether of merchantability, fitness for purpose, or otherwise, are expressly disclaimed by Delta.